

GMC Utilities Group Ltd, GMC House,  
Millenium Business Park, Cappagh Road,  
Ballycoolin, Dublin 11, Ireland.  
Tel: +353 (0)1 864 9800  
Email: info@gmcirl.com

# TRAFFIC MANAGEMENT PACK

**PROJECT**  
3840323 IW CDS New Connection

**LOCATION**  
77 Strand Street, R128, Townparks, Skerries, Dublin



RECOMMENDED PRINT A3 | ISSUED : 17/04/2026 | REVISION - 00 | TMPs - 02 | DESIGNER - G.IONEL | DRAWN - H.DANUT

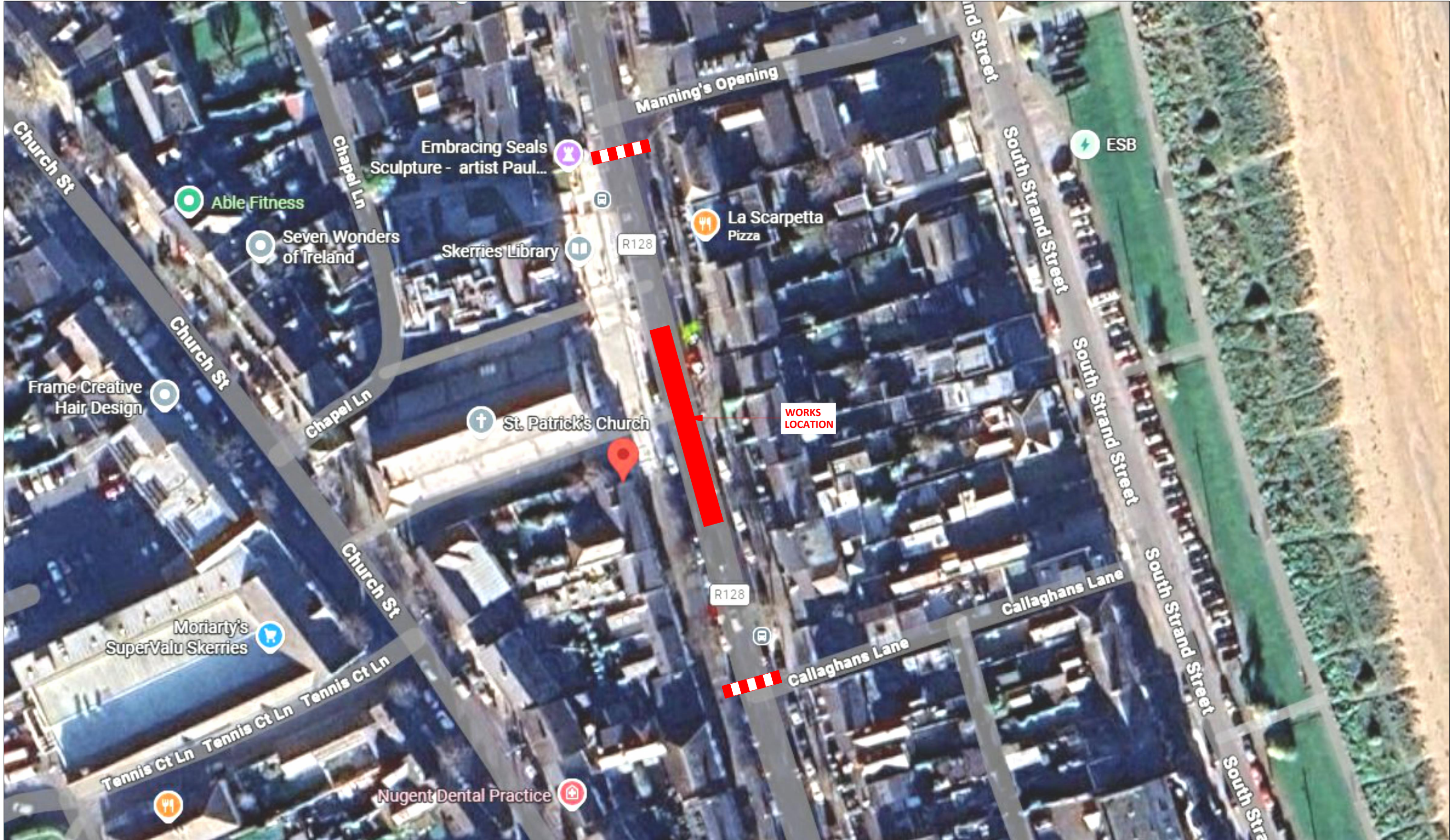

- Traffic Management to comply with Chapter 8 of the "Traffic Signs manual" and "Guidance for the control and Management of Traffic at Road Works".
- A minimum lane width of 3.0m to be maintained at all times.
- On single carriageway roads of 50 km/h signs to be placed at 20m intervals. Additional signage may be used where deemed necessary.(Type A & B)
- Longitudinal safety area of 5m.
- Width of Lateral Safety to be 0.5m.
- Taper to works to be at 45°
- A Pedestrian walkway of 1.2m minimum to be maintained at all times,kerb ramps to be provided where required
- Work Area to be barriered at all times.
- TMP is based on information received at time of design,minor changes may be required on site. Major changes to site works will require revised TMP
- Minimum size of signs to be 600mm.
- Minimum height of cones to be 750mm.
- Below signage to be used where required...



During darkness at unlit areas following a site risk assessment additional lighting to be installed (eg. lamps, sequential lamps, etc)

- LEGEND:**
- PEDESTRIAN ROUTE
  - WORK/PLANT AREA
  - LONGITUDINAL SAFETY ZONE
  - LATERAL SAFETY ZONE
  - PEDESTRIAN BARRIER
  - SITE BARRIER
  - TRAFFIC CONE
  - SIGN LOCATION & ORIENTATION
  - BARRIER BOARD
  - TRAFFIC FLOW
  - DUCTING ROUTE
  - DIVERSION ROUTE
  - DIVERSION ROUTE

Design Parameters for Level 1 (iii) (Single Carriageway 50 km/h)	
Design Parameters	Roadworks Type B (<12 Hours)
Sign Size (mm)	Temporary Signs 600 Min
Sign Visibility (m)	50
Number of Signs	2
Cumulative Distance (m)	40
Distance between advance signs (m)	20
Minimum Rate of Taper	
Taper at Lane (m) <sup>2</sup>	1 in 5
Taper at Hard Shoulder (m) <sup>2</sup>	1 in 5
Maximum Cone Spacing	
Cone Height (mm)	750
At Taper (m) <sup>2</sup>	3
Longitudinal (m) <sup>2</sup>	3
Maximum Lamp Spacing	
At Taper (m)	6
Longitudinal (m)	6
Safety Zone	
Longitudinal (m)	5
Lateral (m)	0.5
Lanes	
Minimum Lane/Width (m)	3 (2.5)
Two-way Roadway Width (m)	5

Note:  
 A. 45 degree taper is required at active temporary traffic controlled layouts with cones at 1m centres.  
 B. Cone spacing shown is the maximum permitted. Where geometry or any other site specific reason dictates the spacing shall be reduced accordingly.  
 C. The optimum lane width for all classes of vehicles is 3.3m. This may be reduced to a minimum of 3.0m. Below this, HGV's and buses must be marshalled past the works. The absolute minimum lane width, if only cars and light vehicles are present, is 2.5m. Refer to Chapter 8, Paragraphs 8.4.3.1 to 8.4.3.3.

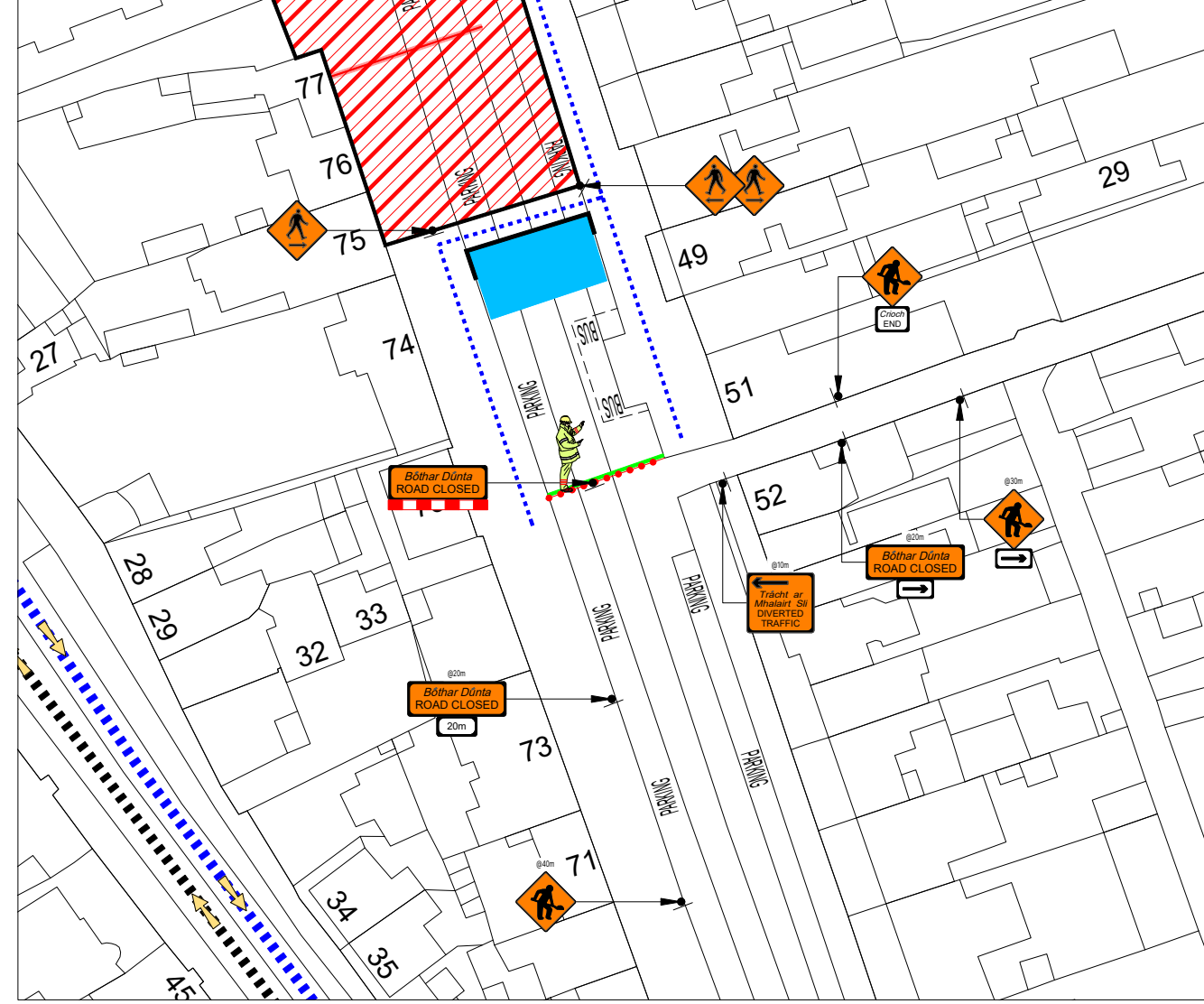
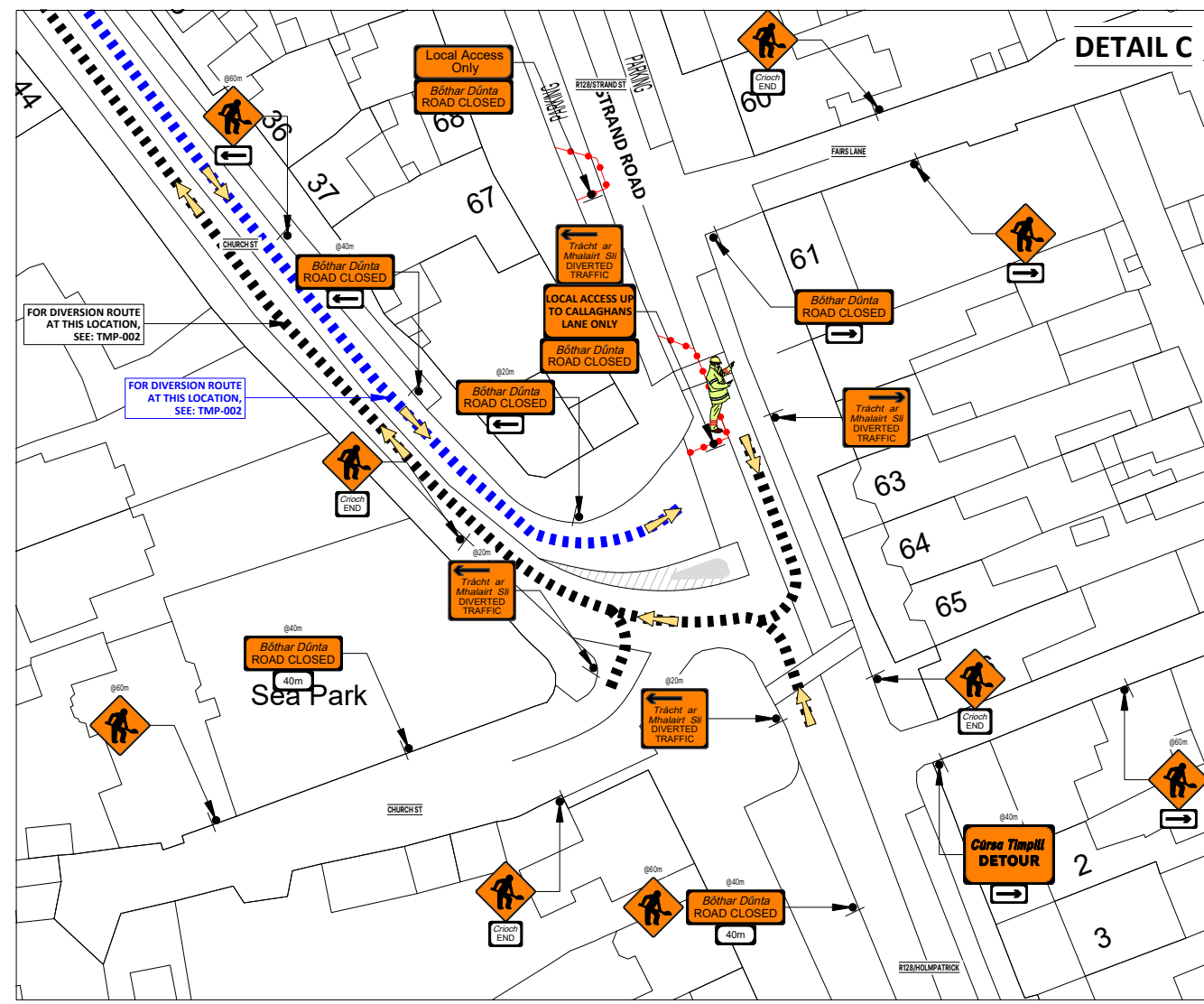
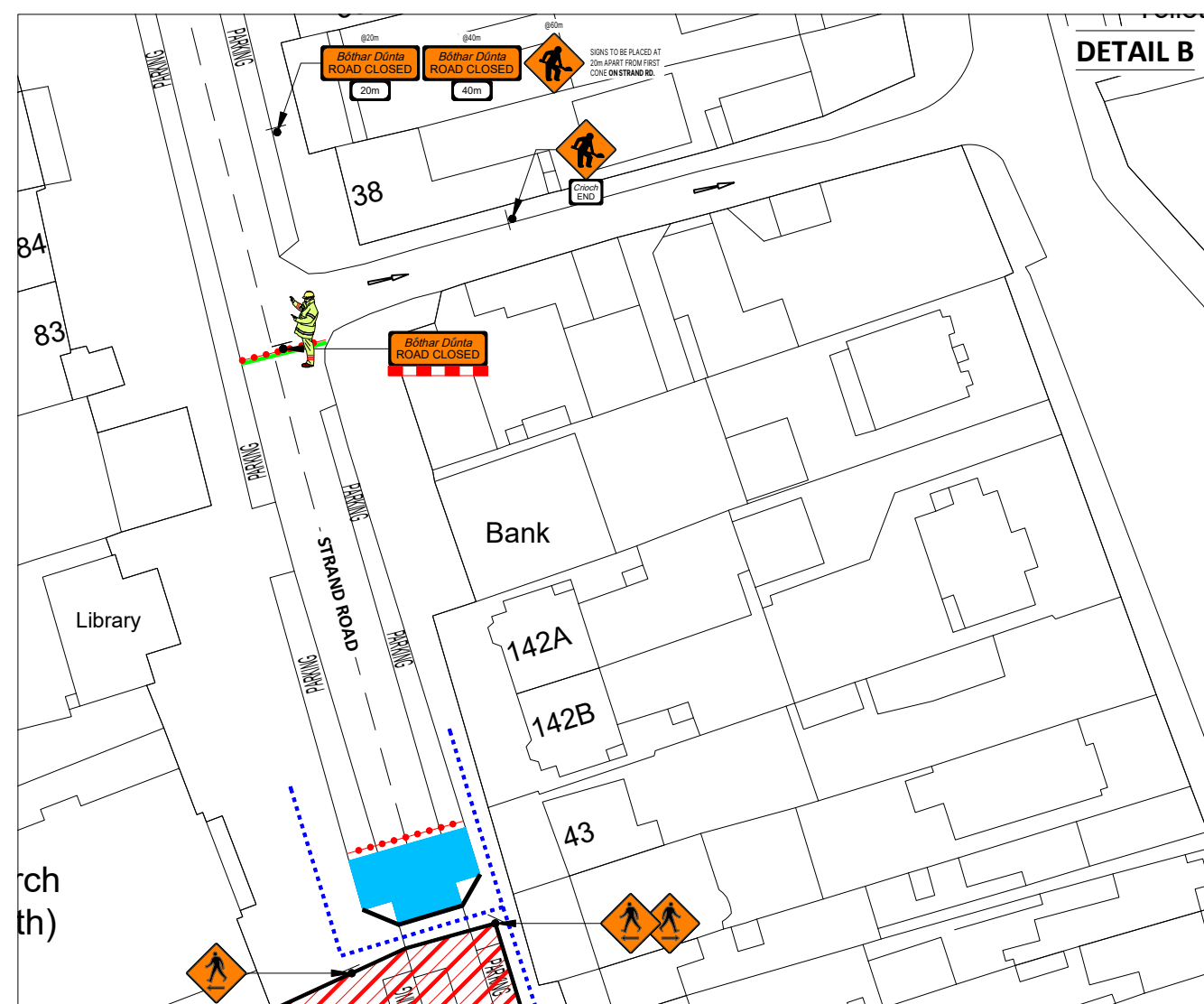
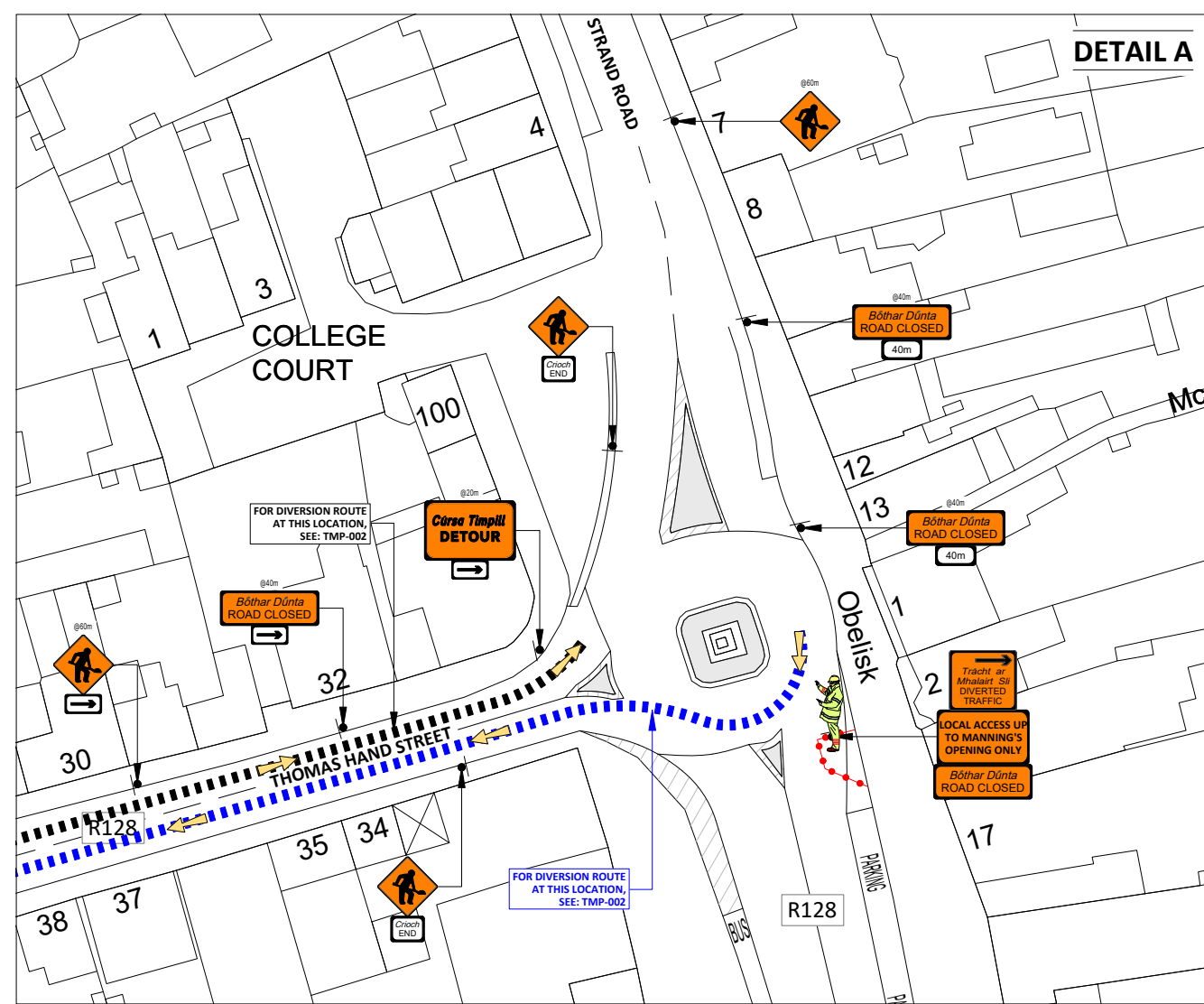

**GMC Utilities Group Ltd**, GMC House, Millenium Business Park, Cappagh Road, Ballycoolin, Dublin 11, Ireland.  
 Tel: +353 (0)1 864 9800  
 Email: info@gmcirl.com

<b>Project ;</b>	3840323 IW CDS New Connection	
<b>Location ;</b>	77 Strand Street, R128, Townparks, Skerries, Dublin	
<b>TM Method ;</b>	Road Closure System	
<b>Designer ; IG</b>	<b>Drawn ; DH</b>	<b>Approved ; DG</b>
<b>Date ;</b>	17/04/2026	
<b>Scale ;</b>	NTS - USE FIGURED DIMENSIONS ONLY	
<b>TMP Guide Reference ;</b>	<b>TMP-001</b>	
<b>Dwg Number ;</b>	<b>GMC-TMP-26567-REV00</b>	

# DIVERSION ROUTE

Skerries Strand North

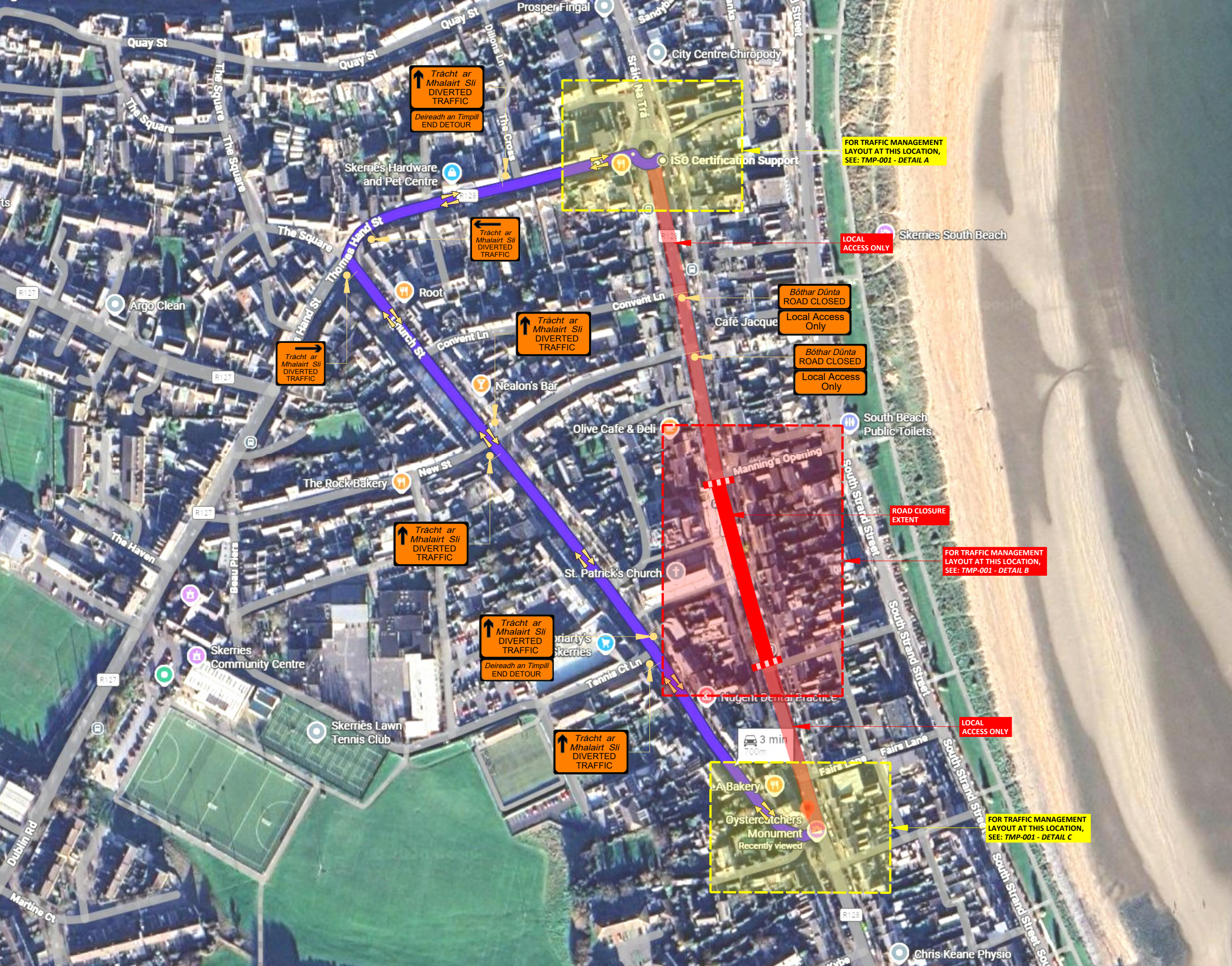

## SITE SPECIFIC NOTES

1. Traffic Management to comply with Chapter 8 of the "Traffic Signs manual" and "Guidance for the control and Management of Traffic at Road Works".
2. A minimum lane width of 3.0m to be maintained at all times.
3. On single carriageway roads of 50 km/h signs to be placed at 20m intervals. Additional signage may be used where deemed necessary.(Type A & B)
4. Longitudinal safety area of 5m.
5. Width of Lateral Safety to be 0.5m.
6. Taper to works to be at 45°
7. A Pedestrian walkway of 1.2m minimum to be maintained at all times,kerb ramps to be provided where required
8. Work Area to be barriered at all times.
9. TMP is based on information received at time of design,minor changes may be required on site. Major changes to site works will require revised TMP
10. Minimum size of signs to be 600mm.
11. Minimum height of cones to be 750mm.
12. Below signage to be used where required...



During darkness at unlit areas following a site risk assessment additional lighting to be installed (eg. lamps, sequential lamps, etc)

**LEGEND:**

PEDESTRIAN ROUTE	.....
WORK/PLANT AREA	.....
LONGITUDINAL SAFETY ZONE	.....
LATERAL SAFETY ZONE	.....
PEDESTRIAN BARRIER	.....
SITE BARRIER	.....
TRAFFIC CONE	.....
SIGN LOCATION & ORIENTATION	.....
BARRIER BOARD	.....
TRAFFIC FLOW	.....
DUCTING ROUTE	.....
DIVERSION ROUTE	.....
DIVERSION ROUTE	.....

Design Parameters for Level 1 (iii) (Single Carriageway 50 km/h)	
Design Parameters	Roadworks Type B (<12 Hours)
Sign Size (mm)	600 Min
Sign Visibility (m)	50
Number of Signs	2
Cumulative Distance (m)	40
Distance between advance signs (m)	20
Minimum Rate of Taper	
Taper at Lane (m) <sup>2</sup>	1 in 5
Taper at Hard Shoulder (m) <sup>2</sup>	1 in 5
Maximum Cone Spacing	
Cone Height (mm)	750
At Taper (m) <sup>2</sup>	3
Longitudinal (m) <sup>2</sup>	3
Maximum Lamp Spacing	
At Taper (m)	6
Longitudinal (m)	6
Safety Zone	
Longitudinal (m)	5
Lateral (m)	0.5
Lanes	
Minimum Lane/Width (m)	3 (2.5)
Two-way Roadway Width (m)	5

Note:  
 A. 45 degree taper is required at active temporary traffic controlled layouts with cones at 1m centres.  
 B. Cone spacing shown is the maximum permitted. Where geometry or any other site specific reason dictates the spacing shall be reduced accordingly.  
 C. The optimum lane width for all classes of vehicles is 3.3m. This may be reduced to a minimum of 3.0m. Below this, HGVs and buses must be marshalled past the works. The absolute minimum lane width, if only cars and light vehicles are present, is 2.5m. Refer to Chapter 8, Paragraphs 8.4.3.1 to 8.4.3.3.



**GMC Utilities Group Ltd**, GMC House, Millenium Business Park, Cappagh Road, Ballycoolin, Dublin 11, Ireland.  
 Tel: +353 (0)1 864 9800  
 Email: info@gmcirl.com

<b>Project ;</b>	3840323 IW CDS New Connection	
<b>Location ;</b>	77 Strand Street, R128, Townparks, Skerries, Dublin	
<b>TM Method ;</b>	Road Closure System	
<b>Designer ; IG</b>	<b>Drawn ; DH</b>	<b>Approved ; DG</b>
<b>Date ;</b>	17/04/2026	
<b>Scale ;</b>	NTS - USE FIGURED DIMENSIONS ONLY	
<b>TMP Guide Reference ;</b>	<b>TMP-002</b>	
<b>Dwg Number ;</b>	<b>GMC-TMP-26568-REV00</b>	