

Copyright: All creative artwork, landscape symbology, text, legends, specifications, descriptions and illustrations used in our drawings and reports are the intellectual property of **ait** urbanism + landscape ltd. and are not to be reproduced by others.

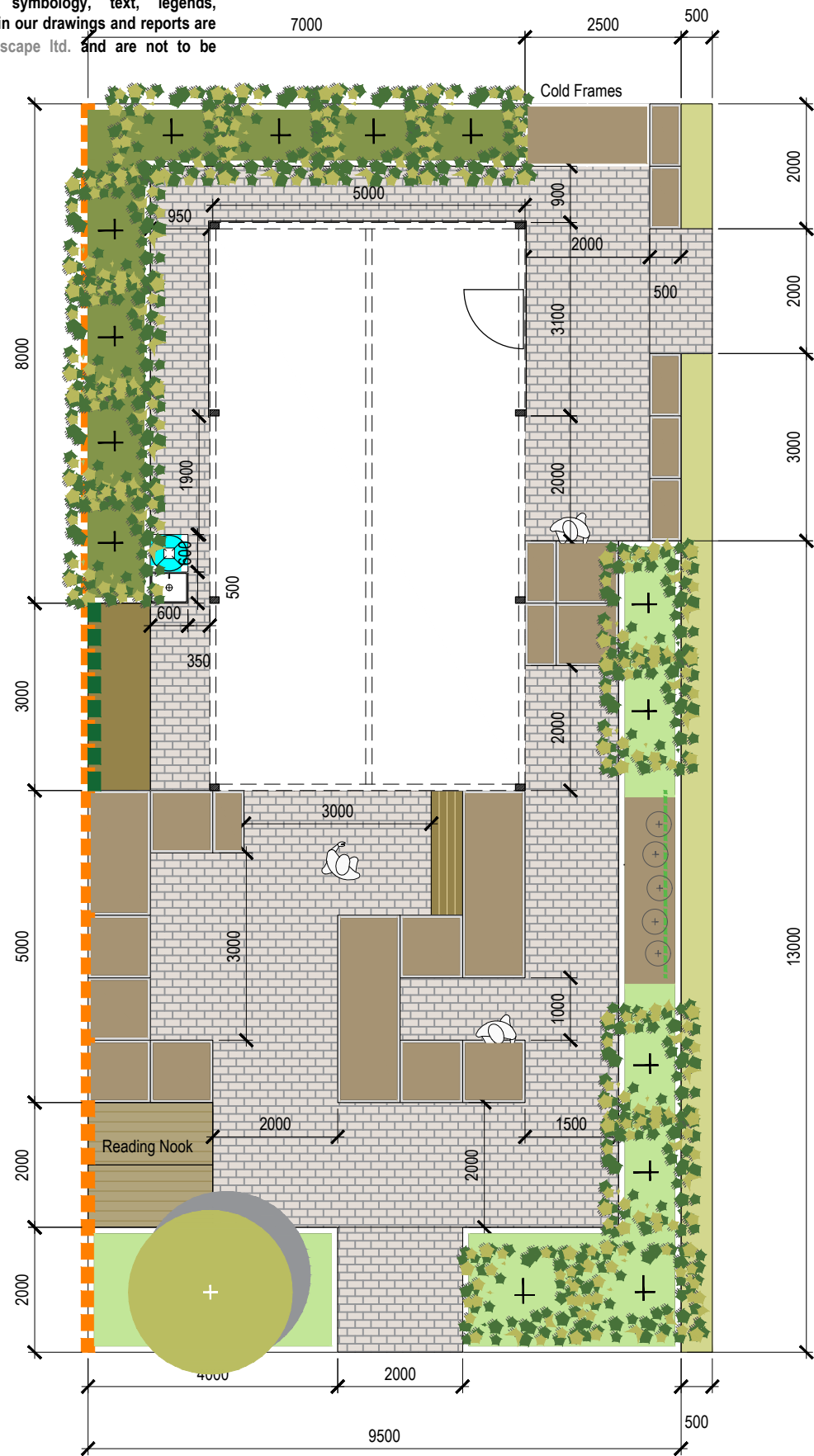

LEGEND

Soft Landscape

- Specimen Multi Stem Tree**
Malus 'Evereste' 3 x tr. Containerised. Multistem, 3.0-3.5m h. min 5 breaks
- Pleached and/or Espalier Fruit Trees**
Malus communis 'Belle De Boskoop', 2.0-1.8m, 2 x tr., containerised 90-100 ltr, Espalier.
Malus communis 'Florina', 2.0-1.8m, 2 x tr., containerised 90-100 ltr, Espalier.
Malus communis 'Golden Delicious', 2.0-1.8m, 2 x tr., containerised 90-100 ltr, Espalier.
Pyrus communis Vars. 2.0-1.8m, 2 x tr., containerised 90-100 ltr, Espalier.
- Climbers**
Sweet pea 2-3ltr. Cane trained. 1.0-1.2m h
Pea selection 2-3ltr. Cane trained. 1.0-1.2m h
- Garden Groundcover Planting 01**
Specimen shrubs
Cornus kousa 'Schmetterling' 7.5-10ltr. c.g.
Sambucus nigra 'Haschberg' 7.5-10ltr. c.g.
Grasses/ Sedges (60%)
Calamagrostis 'Overdam' min 3ltr.
Carex testacea min 3ltr.
Dechampsia 'Goldtau' min 3ltr.
Sesleria nitida min 3ltr.
Flowering Perennials & Herbs (40%)
Achillea millefolium 'Walter Funcke' 2ltr-3ltr.
Alchemilla mollis 2ltr-3ltr.
Anthriscus sylvestris 2ltr-3ltr.
Astrantia major 'Star of Love' 2ltr-3ltr.
Cirsium rivulare 'Atropurpureum' 2ltr-3ltr.
Foeniculum vulgare 'Purpureum' 2ltr-3ltr.
Geum 'Totally Tangerine' 2ltr-3ltr.
Lavandula 'Angustifolium' 5ltr.
Lavandula stoechas 5ltr.
Salvia nemerosa 'Caradonna' 5ltr.
Tagetes patula 2-3ltr.
Valeriana officinalis 2-3ltr.
Allium 'Purple Sensation' 2-3ltr.
Allium schoenoprasum 2-3ltr.
Digitalis 'Pams Choice' 2-3ltr.
All stock extra quality
- Garden Groundcover Planting 02**
Grasses & Sedges (70%)
Carex testacea 3ltr.
Dechampsia 'Goldtau' 3ltr.
Sesleria nitida 3ltr.
Ferns (15%)
Anthriscus sylvestris 3ltr.
Asplenium trichomanes 'incisum' 3ltr.
Blechnum spicant 3ltr.
Cyrtomium fortunei var. 'Clivicola' 3ltr.
Perennials (15%)
Brunnera 'Jack Frost' 3ltr.
Digitalis 'Pams Choice' 3ltr.
Digitalis 'Snow Thimble' 3ltr.
Epimedium grandiflorum 'Lilafee' 3ltr.
Geranium macrorrhizum 'Spessart' 3ltr.
- Vegetable & Crop Produce (for growing on)**
Fruit
Cherry Tomatoes (10.5cm)
Yellow Cherry Tomatoes (10.5cm)
Tomatoes vars (10.5cm)
Salads & Soft Herbs
Basil 14cm Ø pot
Coriander 14cm Ø pot
Mentha Spp. 18cm Ø pot
Satureja montana 18cm Ø pot
Mixed Leaf Salad 10 pack tray
Rocket Plug Plants 10 pack tray
Scallion Plug Plants 10 pack tray
Vegetables
Globe artichoke 5ltr.
Beetroot (in variety of colours) plugs 10 pack tray
Carrot 10 pack tray
Chard (in variety of colours) plugs 10 pack tray
Courgette Plants 10.5cm pots
Kohlrabi plugs 10 pack tray
Pea plugs 10 pack tray
Sweet Pea 10 pack tray
Sweet Corn plugs 10 pack tray
Rhubarb 10.5cm pot
- Living Wall Planter**
Strawberries in variety:
Fragaria vesca 9cm pots
Fragaria v. 'Improved Rugen' 9cm pots
Fragaria 'Malling Centenary' P13
Fragaria sonata P13
Beltran P12
Nasturtium Plug Plants P9
- Lawn Verge**

This drawing is the copyright of **ait** urbanism + landscape. Unless otherwise stated all dimensions are in millimetres. Where dimensions are not given, drawings must not be scaled and the matter must be referred to the Landscape Architect. If the drawing includes conflicting details/dimensions the matter must be referred to the Landscape Architect. All dimensions must be checked on site. The Landscape Architect must be informed, by the Contractor, of any discrepancies before work proceeds.

NOTES:

DATE	REV.	DESCRIPTION	DRAWN BY:	CHECKED BY:
-	-	-	-	-

	3rd Floor Newmarket House, Newmarket Square, Dublin 8 Ireland t: + 353 86 1739522 www.ait-place.ie		ISSUE STATUS: INFORMATION	REVISION: P01	
	CLIENT: Fingal County Council		DRAWING NO.: 26FG01-0300	DRAWN BY: CH	
PROJECT: Bloom 2026		PROJECT NO.: 26FG01	SCALE: 1:100	SHEET SIZE: A3	CHECKED BY: RJ
DRAWING: Landscape Planting Plan		DRAWING NO. 26FG01-0300			