

# New Street Public Realm - Preliminary Design Drawings

Design Development

## Key Design Moves

1

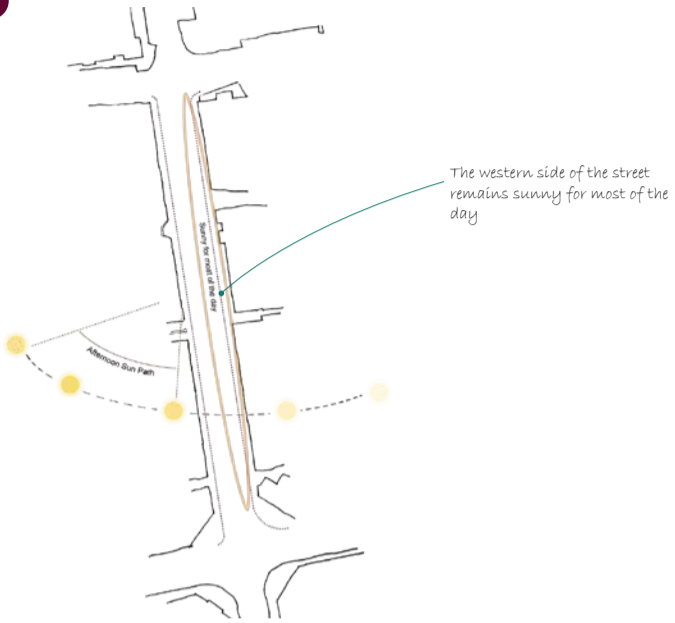

2

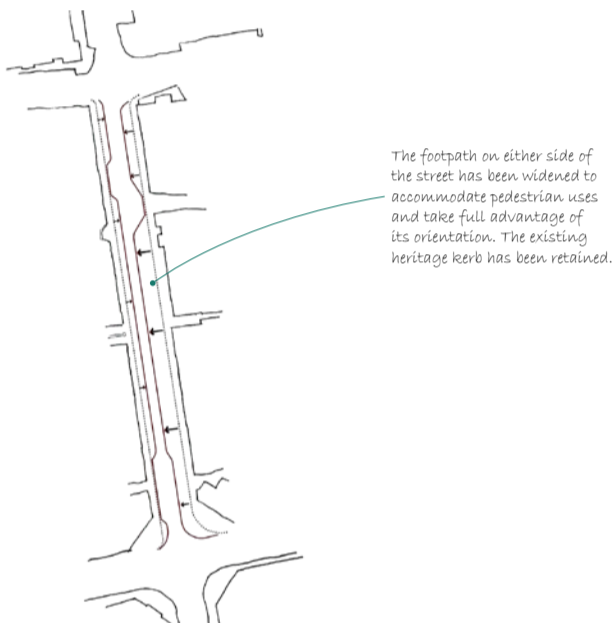

3

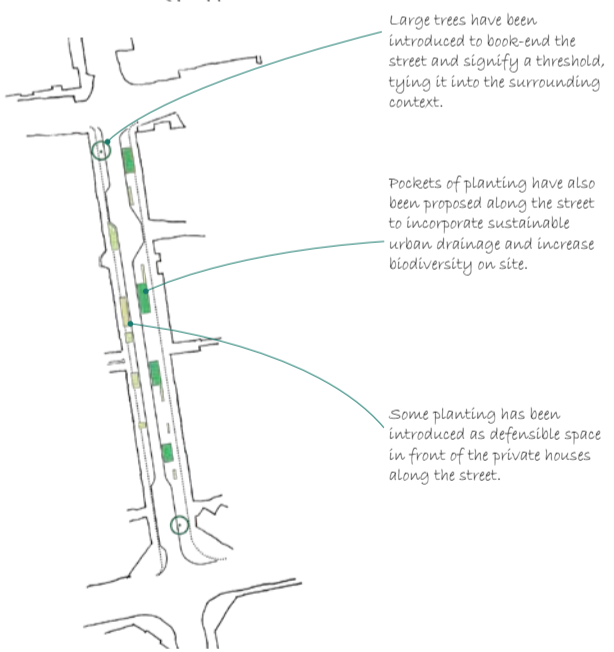

4

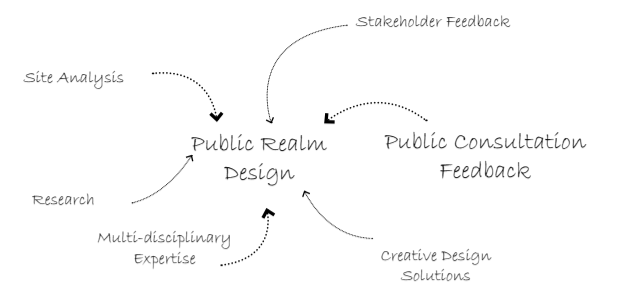
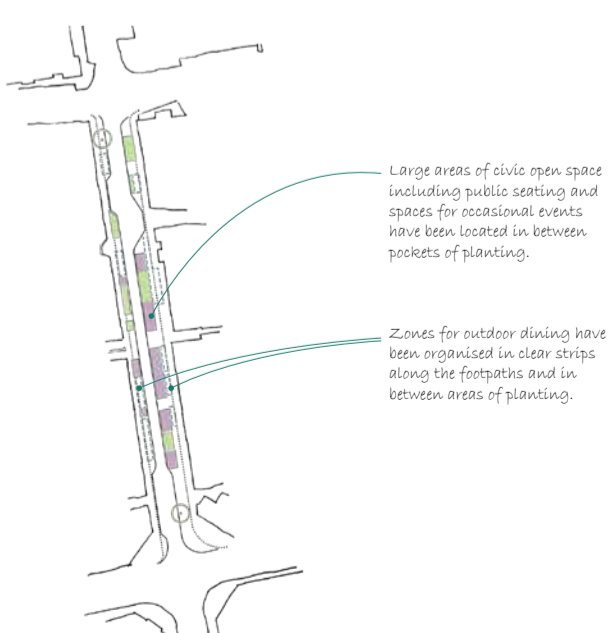

Large trees form structural elements within the wider landscape and help to integrate the street within the wider context



No seating has been proposed in front of private houses. Large areas of planting have been introduced as defensible space



A constant footpath has been maintained along the building edge



A clear delineation has been proposed between the carriageway and the designated pedestrian zone



High quality materials have been proposed throughout to complement the existing character of the site



No seating has been proposed in front of private houses. Large areas of planting have been introduced as defensible space



The existing heritage kerbs have been retained as part of the public realm design



A variety of options for comfortable public seating have been proposed in the civic zones along the street



The pockets of vegetation along the street incorporate small flowering trees, formal hedge planting and colourful groundcover planting to increase biodiversity. They will also act as sustainable urban drainage features



The current arrangement of disabled parking and loading bays has been maintained as part of the proposed design



The maintenance of the public realm has been a key consideration as part of the public realm design



A clear delineation has been proposed between the carriageway and the designated pedestrian zone

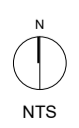

# New Street Public Realm - Preliminary Design Drawings

## Diagrams

### Wider Context



The aim is to realise the street's potential, to strengthen the sense of identity, create a place of interest at the heart of the town and provide a high quality, modern, durable pedestrian friendly environment that enhances the public realm while respecting the historic context of Malahide and further fostering its competitive edge...

- FCC Project Brief, 2022

- Greenway
- Proposed Primary / Secondary Cycle Routes
- Main Flow of Pedestrian Movement
- Main Flow of Movement

### Diagrams



# New Street Public Realm - Preliminary Design Drawings

Axonometric Illustration

## East Side

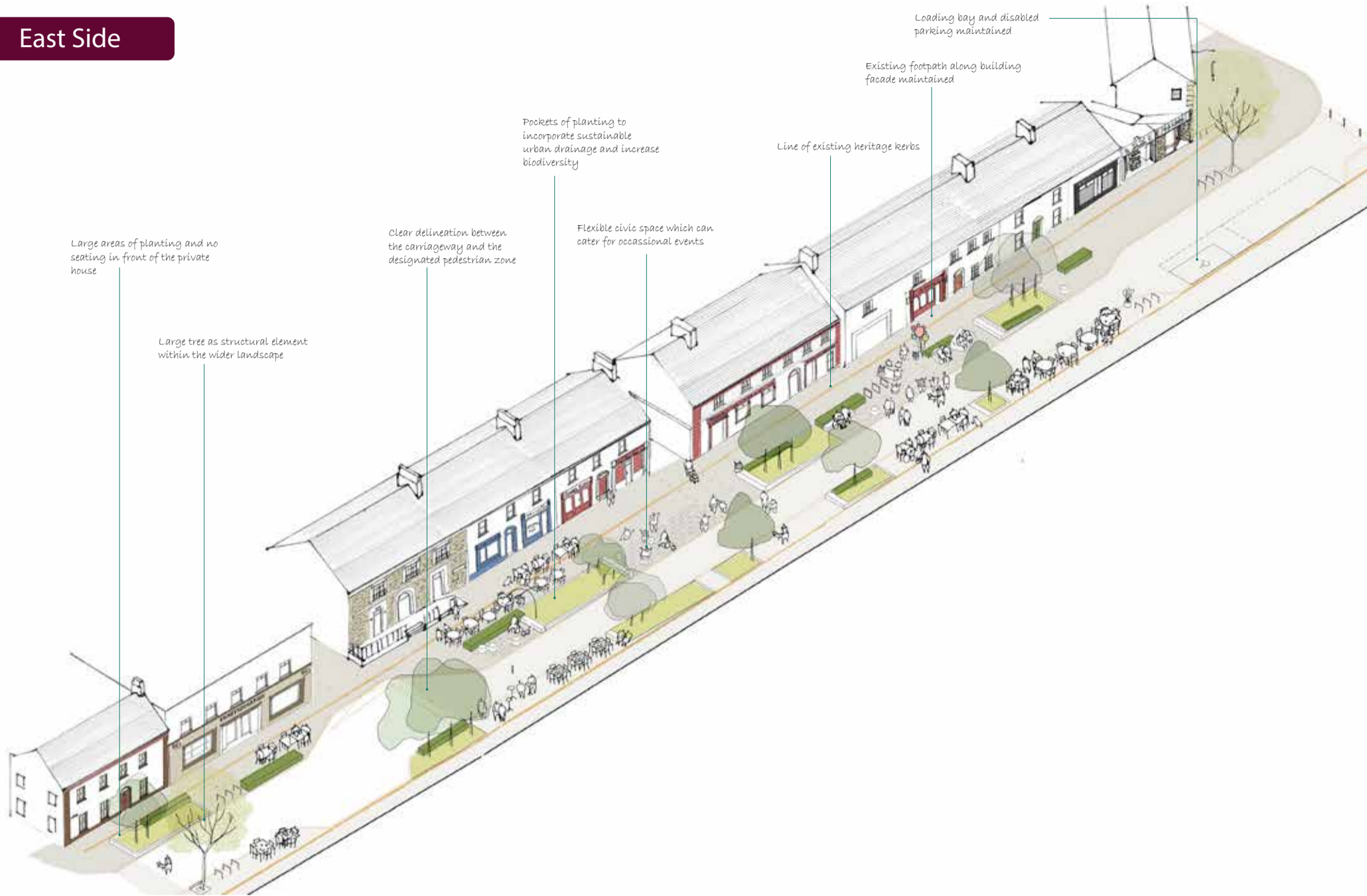

## West Side

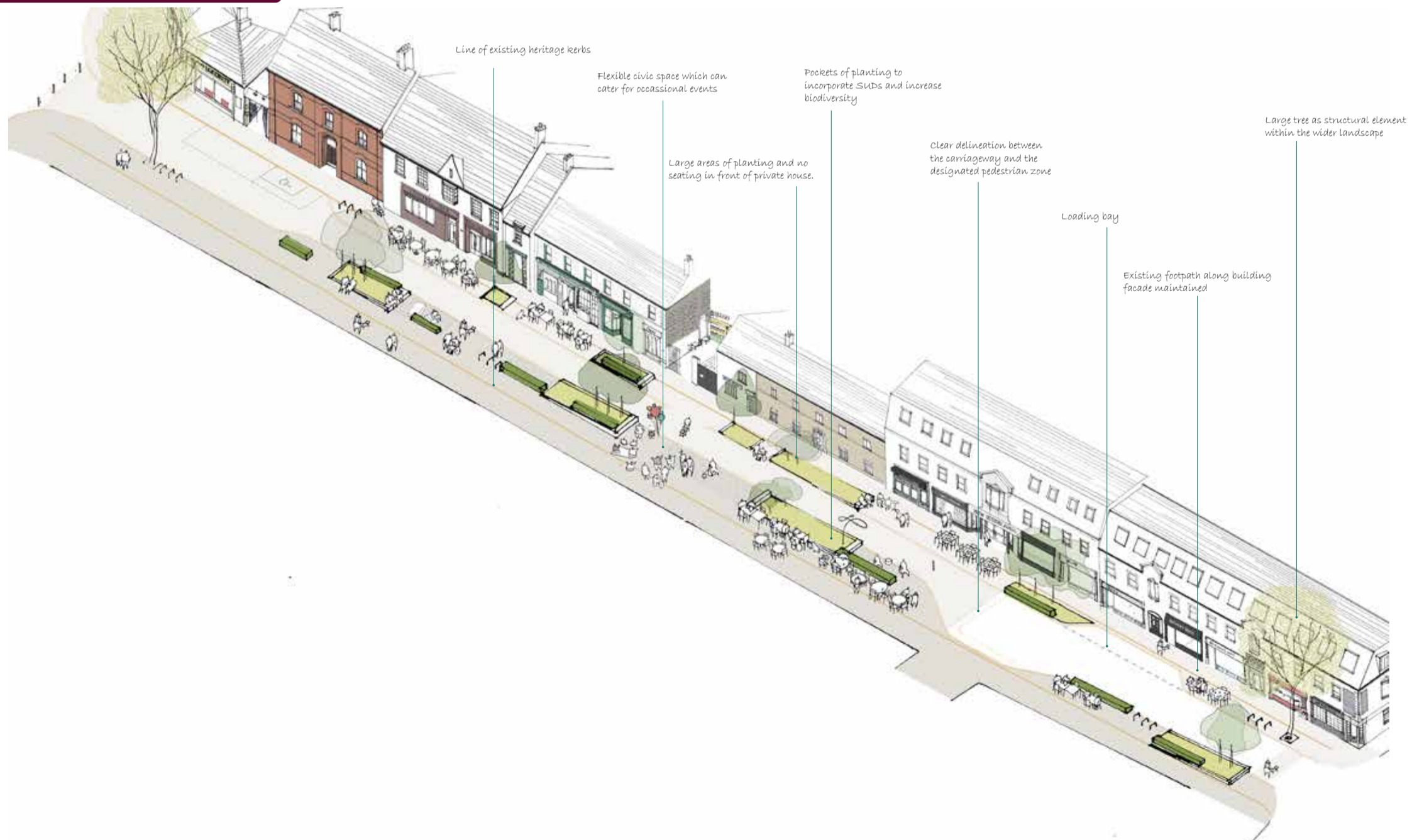

# New Street Public Realm - Preliminary Design Drawings

Perspective 01

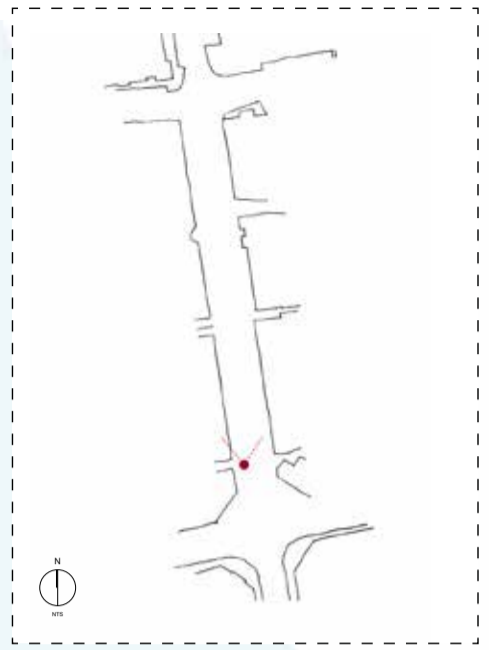

Key Plan



Existing heritage kerb

A space to dine outside

A safe space to meet friends outside

Integrated seating

Playful paving as a 'rug', delineating the civic open space from the zone of outdoor dining

Small trees with seasonal interest

Pockets of planting to incorporate sustainable urban drainage and increase biodiversity

Informal and movable seating

Hedge planting to add form and structure to the street

Cyclists will dismount along New Street

# New Street Public Realm - Preliminary Design Drawings

Perspective 02

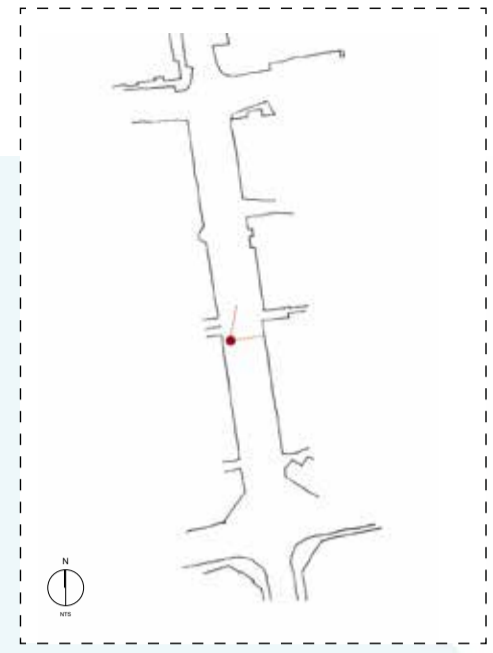

Key Plan



Flush kerb

A large tree at either end of the street will help to signify a threshold

High quality materials that are durable and easily maintained

Flexible civic space that can be used for street performance and outdoor exhibitions

Small trees with seasonal interest

Colourful and ornamental planting that is pollinator-friendly

Hedge planting to add form and structure to the street

Existing footpath along building facade maintained

# New Street Public Realm - Preliminary Design Drawings

Perspective 03

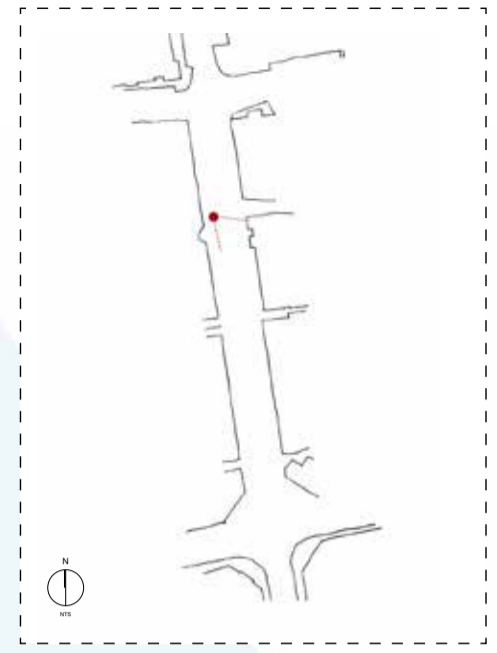

Key Plan



A safe space to meet friends outside

Informal and movable seating

Hedge planting to add form and structure to the street

A potential art installation that creates a unique spatial experience along the street

Integrated seating

Outdoor dining

Existing heritage kerb

Existing footpath along building facade maintained

Colourful and ornamental planting that is pollinator-friendly

