

CAPTAIN'S COURT ESTATE MAP – Scale 1 : 500

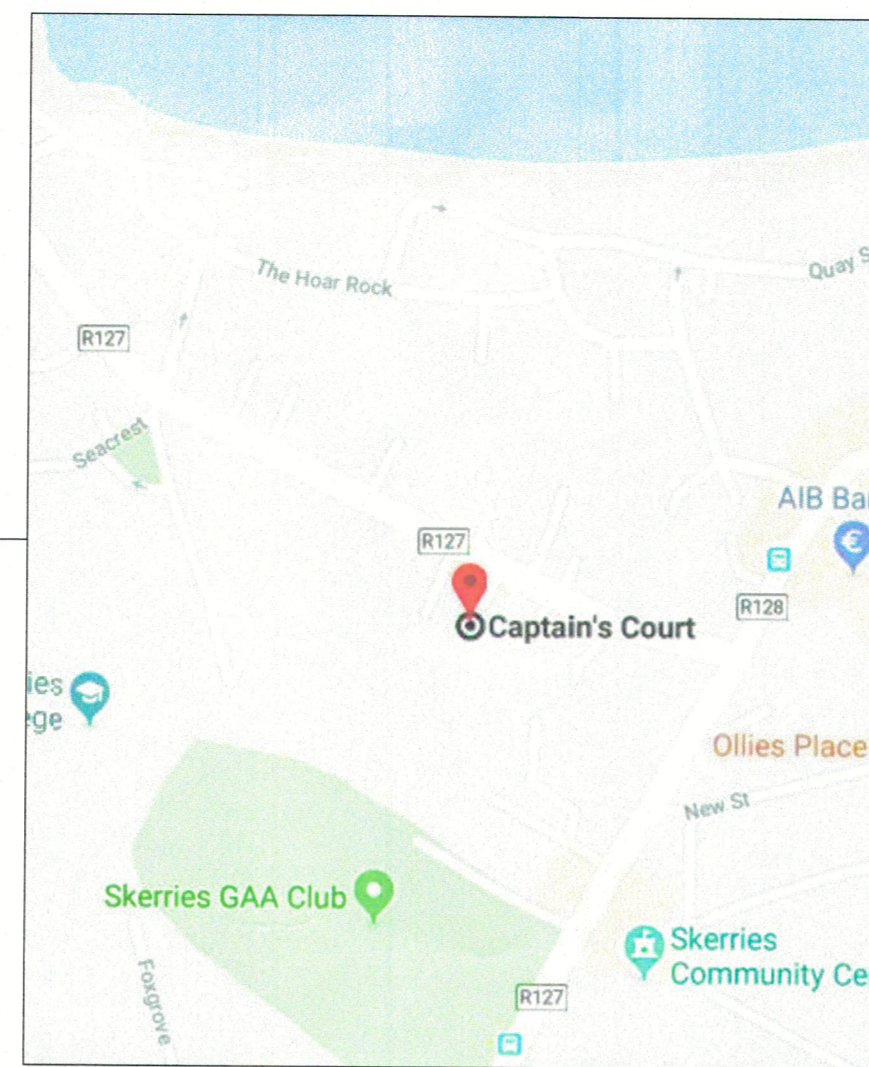

LOCATION MAP NTS

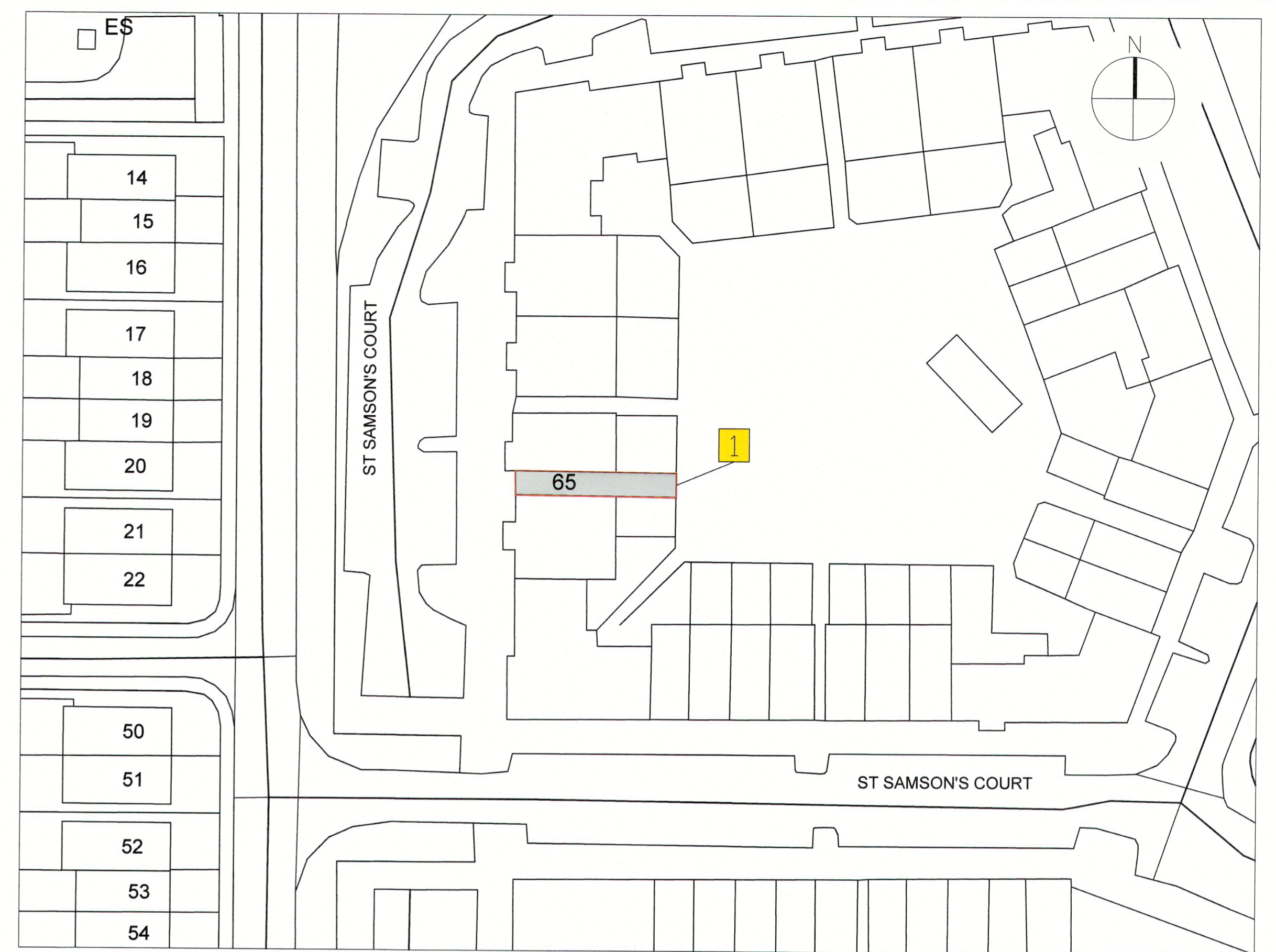

ST SAMSON'S COURT ESTATE MAP – Scale 1 : 500

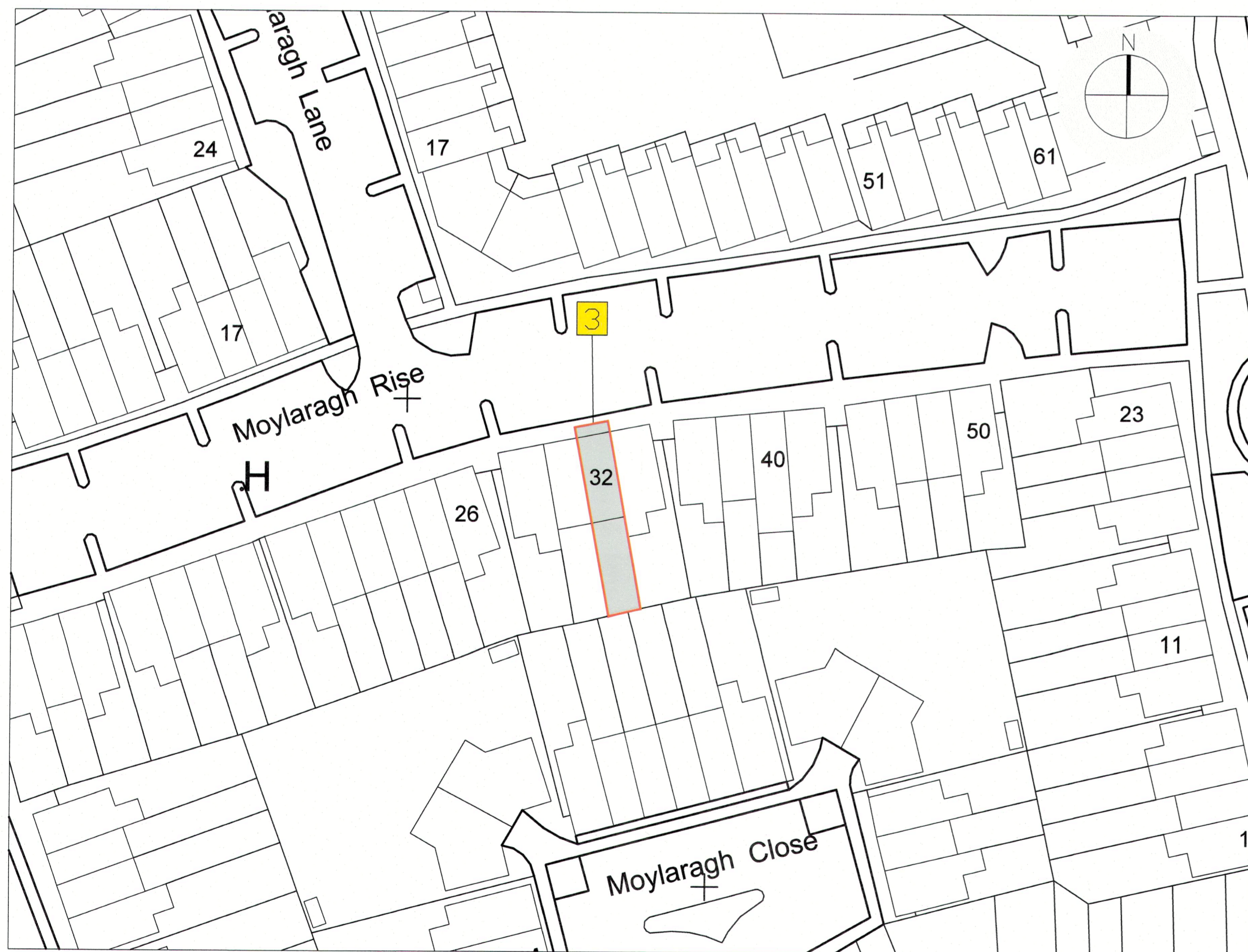

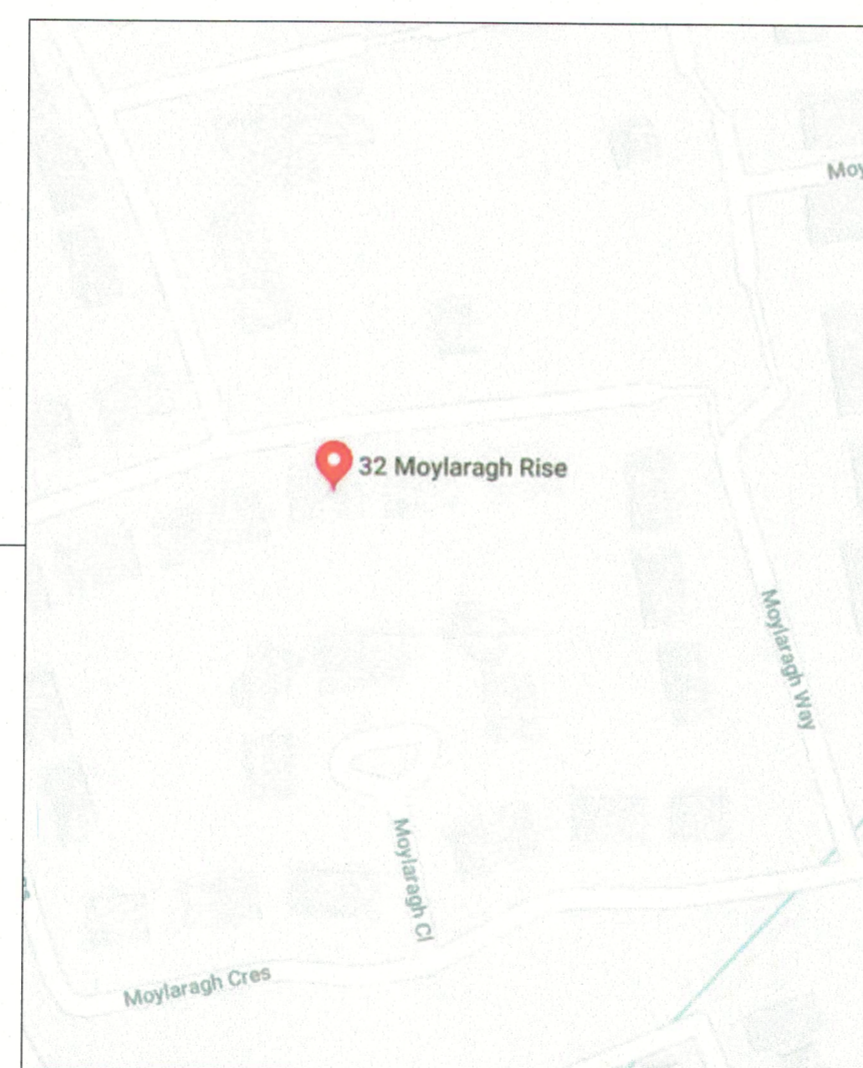

MOYLARAGH ESTATE MAP – Scale 1 : 500



LOCATION MAP NTS

Plot Number	Address
1	65 Samson's Court, Balgriffin, Dublin 13.
2	2 Captain's Court, Balbriggan Street, Skerries, Co Dublin.
3	32 Moylaragh Rise, Balbriggan, Co. Dublin.

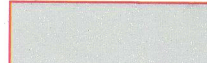
**LEGEND**

PERMANENT ACQUISITION   
 PLOT REFERENCE 

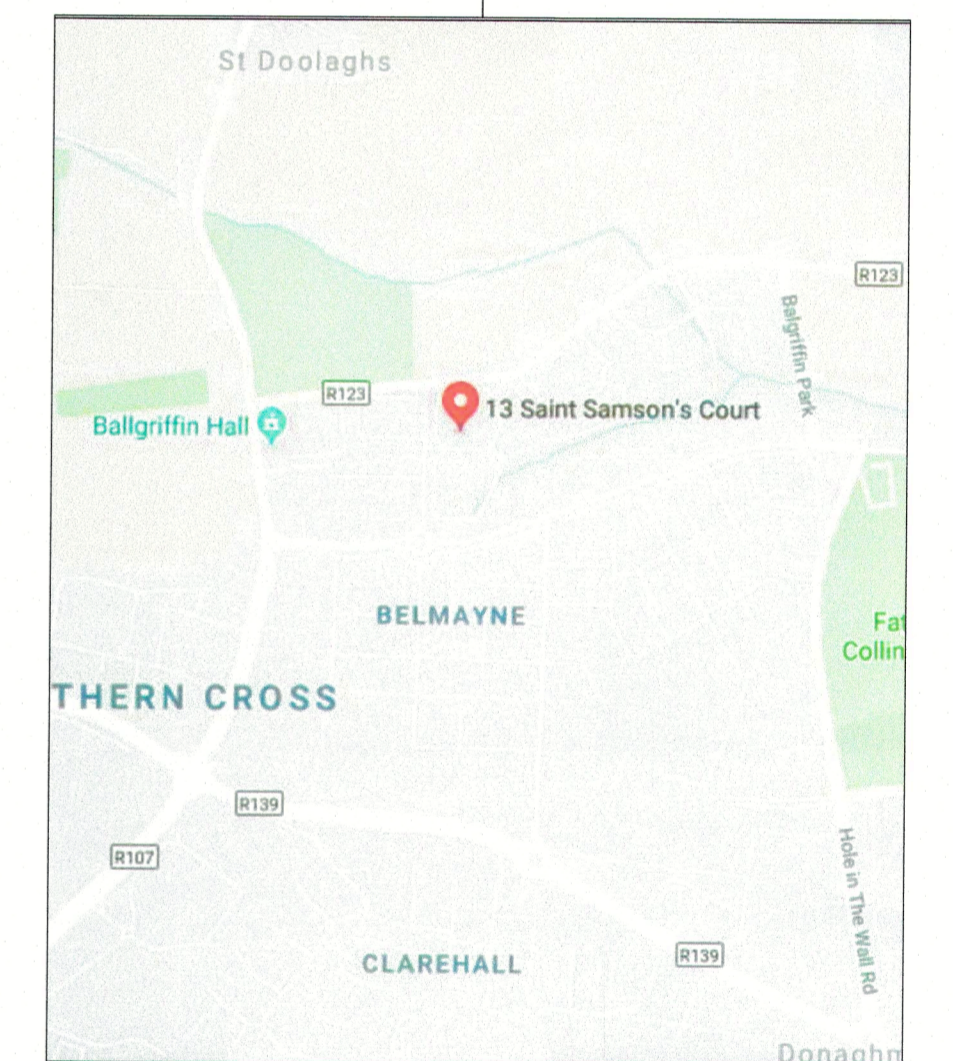

LOCATION MAP NTS

**Comhairle Contae Fine Gall**  
**Fingal County Council**  
 County Hall, Main Street,  
 Swords, Co Dublin.  
 K67 X8Y2  
 Tel: 01 890 5000

PRESENT when the Seal of FINGAL COUNTY COUNCIL was affixed hereto :-  
 MAYOR / NOMINATED EMPLOYEE  
 CHIEF EXECUTIVE  
 DIRECTOR OF SERVICES (ECONOMIC, ENTERPRISE & TOURISM DEVELOPMENT)  
 DIRECTOR OF SERVICES (HOUSING DEPT.)  
 Dated the 13<sup>th</sup> day of December 2019

*Alain O'Connor*  
*Alan FOS*  
*Paul Horan*  
*Reginald Dwyer*

**FINGAL COUNTY COUNCIL**  
**COMPULSORY PURCHASE**  
**(65 St Samson's Court, Balgriffin, 2**  
**Captain's Court, Balbriggan Street,**  
**Skerries and 32 Moylaragh Rise,**  
**Balbriggan, Co Dublin) ORDER 2019**

Title:  
**DEPOSIT MAP**  
**Sheet 1 of 1**

Drawn by: **MMcN**  
 Checked by: **MMcN**

Date: **November 2019**  
 Scale: **1 : 500 @ A1**  
 Dwg. No.: **19-380-M-1001**  
 Rev.: